

WIDTH OF EQUIPMENT	HEIGHT OF LEGS
UP TO 24" [UP TO 600 mm]	24" [600 mm]
24" TO 48" [600 mm TO 1.2 m]	36" [900 mm]
48" AND WIDER [1.2 m AND WIDER]	48" [1.2 m]

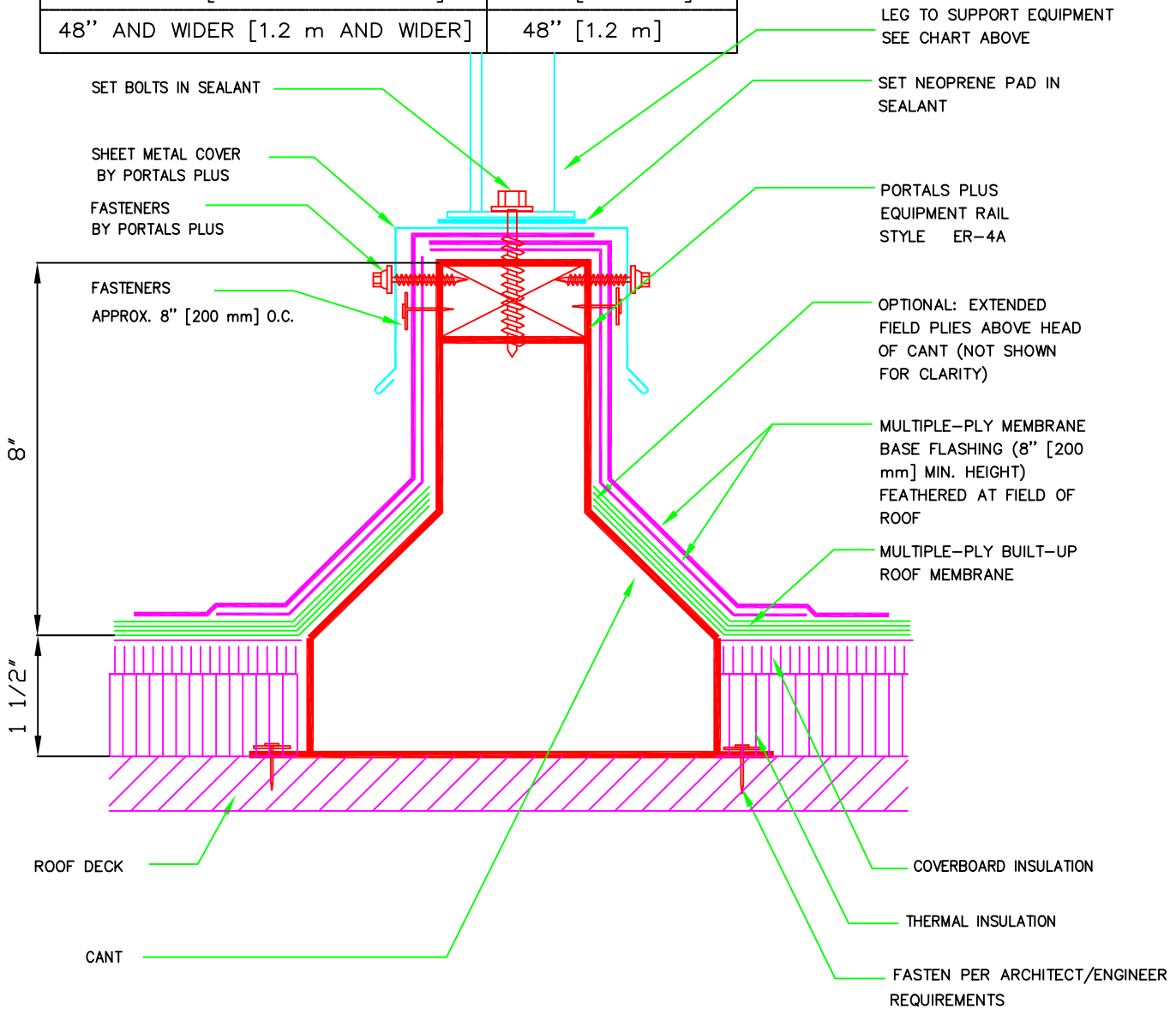

NOTES:

1. THIS DETAIL ALLOWS FOR MEMBRANE MAINTENANCE AROUND THE SUPPORTED EQUIPMENT. THE CONTINUOUS SUPPORT IS PREFERRED IN LIGHT-WEIGHT STRUCTURAL SYSTEMS BECAUSE THE EQUIPMENT WEIGHT CAN BE SPREAD ACROSS TWO OR MORE SUPPORTING MEMBERS

EQUIPMENT SUPPORT RAIL

PORTALS PLUS IS A SUPPLIER OF PREFABRICATED ROOF ACCESSORIES AND DOES NOT ASSUME RESPONSIBILITY FOR ERRORS IN DESIGN, ENGINEERING OR INSTALLATION. THE ROOFING SYSTEM MANUFACTURER'S INSTALLATION REQUIREMENTS MAY SUPERSEDE THESE DETAILS FOR WARRANTED ROOF SYSTEMS.

2003 NOT DRAWN TO SCALE BUR-9S-4A